

Estate Agents



Auctioneers



**Andbourne Court, 10 Admiralty Road, Southbourne, Bournemouth.
BH6 4BL
£140,000 Leasehold**

One Bedroom First Floor Retirement Flat with Sea Views
Communal Entrance | Residents Lounge | House Managers Office | Communal Laundry
Overnight Guest Suite | Stairs and Lift to all Floors | Private Hallway with Storage
Living Room with sea Views | Double Bedroom | Modern Kitchen | Modern Shower Room

Andbourne Court, 10 Admiralty Road, Southbourne, Bournemouth. BH6 4BL

£140,000 Leasehold

SEA VIEWS! A first floor one bedroom retirement apartment situated in this ever popular block, set in a quiet position in the heart of Hengistbury Head and offering sea views from the lounge. The flat is offered for sale with no onward chain.

The development has a House Manager, a communal lounge with sea views and organised activities, communal laundry and a guest suite for visitors to stay overnight (charges apply). The property is surrounded by pleasant communal grounds with patio seating area and the clifftop and beaches are only 100 yards away.

The apartment itself features double glazing, electric heating, modern kitchen with built-in oven & hob and space for fridge and freezer, reception room with bay window enjoying sea views, double bedroom with fitted wardrobes and a modern shower room comprising shower cubicle, w/c and basin all with stylish white tiling.

Tenure: New 150 Year Lease
Service Charge: £3,074.88 per annum
Council Tax Band: B

EPC Rating: 75 | C
Ground Rent: Nil

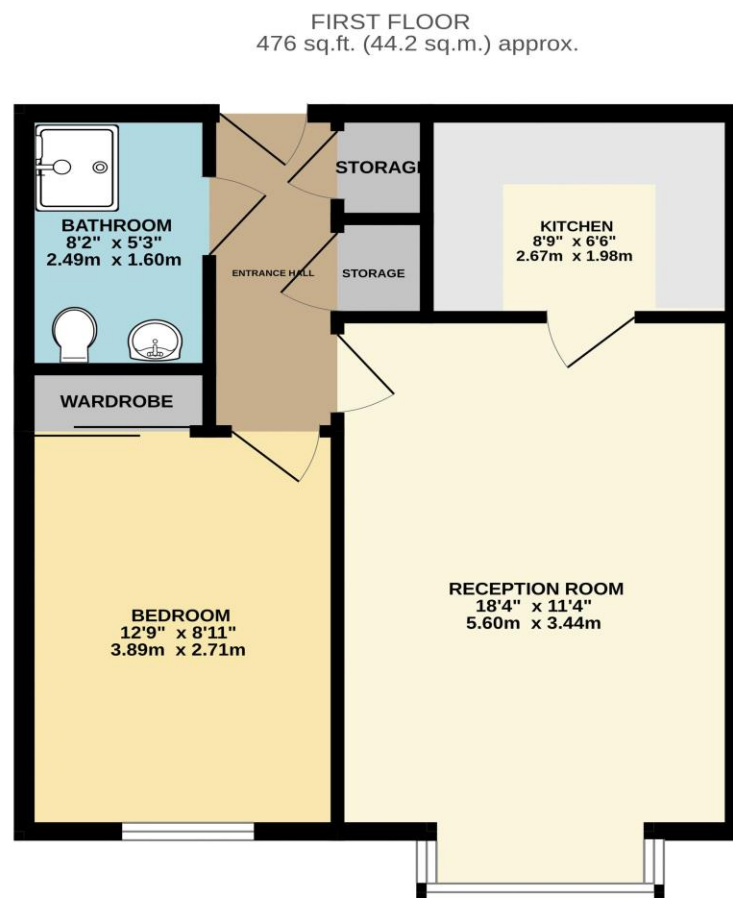

TOTAL FLOOR AREA : 476 sq.ft. (44.2 sq.m.) approx.
Whilst every attempt has been made to ensure the accuracy of the floorplan contained here, measurements of doors, windows, rooms and any other items are approximate and no responsibility is taken for any error, omission or mis-statement. This plan is for illustrative purposes only and should be used as such by any prospective purchaser. The services, systems and appliances shown have not been tested and no guarantee as to their operability or efficiency can be given.
Made with Metropix ©2024

These particulars, whilst believed to be accurate are set out as a general outline only for guidance and do not constitute any part of an offer or contract. Intending purchasers should not rely on them as statements of representation of fact, but must satisfy themselves by inspection or otherwise as to their accuracy. We have not carried out a detailed survey nor tested the services, appliances and specific fittings. Room sizes should not be relied upon for carpets and furnishings. The measurements given are approximate. No person in this firm's employment has the authority to make or give any representation or warranty in respect of the property.